

THE BUILDINGS OF MOREFA BORTH

- the Marsh Harbour

Ceredigion



That part of Borth Village on a pebble bank with the sea on one side and the Cors Fochno marsh some reclaimed and the railway on the other. In the distance is the River Dyfi. Photograph Michael Lewis

Photographs and History by BERYL LEWIS

This work is for research and educational purposes only.

YNYS VIEW Morfa Borth

Part of a terrace on the beach side at the southern part of Borth High Street. Formerly Clifton House and before that Number 2 Amity Place. On the site of an old cottage. Used for relatives of master mariner John Davies who built the cottage, later Amity House and now Celtic.



TOP Ynys View in 2009. BELOW Celtic (formerly Amity House) and Ynys View now part of a terrace with Epworth.

Ynys view is a single fronted, two storey house, part of a terrace, and with its front door on the north side. It shares a gable roof parallel to the road with Celtic and Epworth House. There are two roof lights for an attic floor. The walls are rendered with rough cast and match those of Celtic. The upper window which is modern but in the style of an old sash window does not match Celtic's upper windows, it is lower down. On the ground floor is a box bay window whose hipped roof extends to the window sill of the upper window. The front door has a narrow rectangular light above it to light the hall and the door is wooden, with panels. The front door opens directly on to the street. In 2015 the base of the walls ended in a dark coloured plinth.

At the back a large dormer window in the roof that matches the one on Celtic gives a fine view





of the sea to the attic. Like Celtic next door this house too has an extension into the yard under a gable roof at right angles to the main house. This too has a large window overlooking the beach, and these rear windows are modern. There is room for a shed in its yard, and the tall wall of Epworth House encloses the yard on the north side. Board fencing encloses the rear of the yard, and there is an area of hard standing before the Council's sea defensive wall of vertical sleepers. It is not clear if any of Ynys View's board fence removes to allow access to the beach.

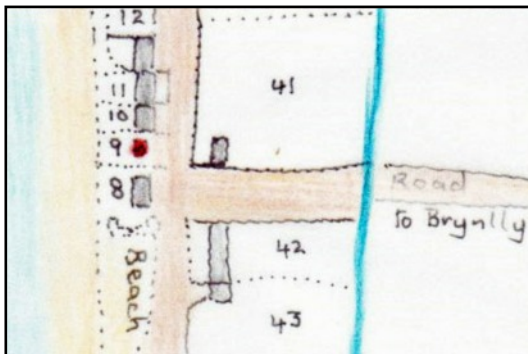

A detail copied from the map of 1829. John Davies cottage is marked in red and was Number 9. Opposite was a small cottage belonging to the Vicar, and a school would be built on his ground, Number 41.

The ground for this house is the stone embankment thrown up by the sea and called 'waste' by the Crown Manor who owned it as it was no use for farming. A plot was enclosed in 1824 by John Davies for a very small cottage, the ground measured only 16 perches - a rod, a quarter of an acre, was 40 perches. A rent of 16s had to be paid every year, or for twice that amount the Davies family could buy the plot (National Archive, map and details, 1829, LRRO 1/3060). The road had been there for centuries and was a turnpike road by the 1770s. It led to a ferry from Ynyslas to Aberdovey, a quick way to North Wales. Fresh water for the old cottages came from a 'brook' behind the cottages on the other side of the road, and for fuel the villagers could dig peat on the far side of the River Leri just north of Ynys Fergi. John Davies the master of Amity enclosed the plot

for his cottage in 1824 four years before the next door ground was enclosed and a cottage, Number 10, built there, for, or by Morgan Jones in 1828. It too was very small just 8 perches.

John Davies was master of the Amity in 1825, 1838 and 1847. His son David Davies was also master of her. She was an 80 ton sloop, and built at Derwenlas in 1802, and was a wooden sailing vessel in the coastal trade, and sailed from Aberdovey harbour. John Davies had 16 of her 64 shares (Shipping Register, Aberystwyth, Ceredigion Archives). She traded with Ireland

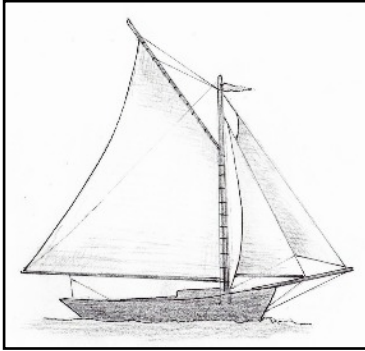

A Sloop

between 1803 and 1809 during the war in Europe and could carry as much as 98 tons of coal. She sailed to London three times in 1803 with slates from Carnarvon, and being a larger sloop could visit European ports. She also carried iron ore to Newport and Cardiff from Pilfinder near Barrow in Furness Cumberland, and coal from Cardiff and the Dee, and oak bark from Chepstow to the Irish Tanneries (Lewis Lloyd, 'A Real Little Seaport, Aberdyfi, the Port and its People 1565 to 1930). John Davies's son John had 12 shares in the Amity by 1853, but in 1858 she was a total wreck when driven ashore at Mulloceck Bay, near Dolbycael, Ireland. John Davies the younger, also a master mariner owned all the shares in the sloop Venus, and shares in several other vessels (Shipping Register, Aberystwyth, Ceredigion Archives).

In the 1871 Census it is not possible to find this house. At some time certainly before 1881 two new houses were built on the site of the old cottage, a double fronted Amity House (Celtic) Amity Place Number 1, and a single fronted one, Amity Place Number 2 (Ynys view). Every foot of the width of the old Davies ground was used, and this second one could not be very wide so as to fit it on.

In 1881 the house was called Number 2 Amity Place. Living there was a young mariner's wife, Mary Davies aged 25. Also there was her sister Jane Jones aged 23, and Margaret Richards aged 19 and earning a living as a dressmaker whose mother, then a widow was living next door in Number 1 (Amity House, now Celtic). These were part of John Davies of Amity's family.

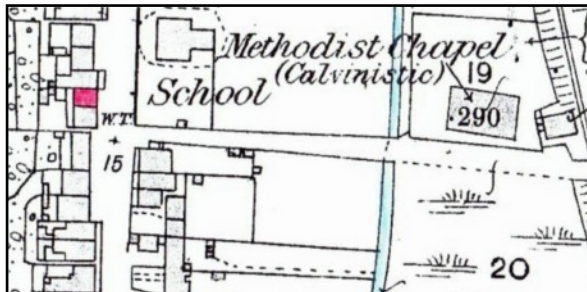

Mary Davies house in 1886 is marked in red. It shared its back yard with Amity House (Celtic), indicating the same owner for both. One of the small buildings in their backyard will have been a Ty Bach (outside lavatory). Detail from the 25 inch Ordnance Survey Map surveyed in 1886 published in 1888. Cardiganshire III.10.

At the 1891 Census the house was no longer Number 2 Amity Place, but was called Clifton House. Mary Davies still there. Her 63 year old mother Mary Richards the daughter of John Davies and Margaret was also in the house, and so was Mary's niece Daisy Hughes.

In 1901 at the Census the house was called Clifton House and no-one was there.

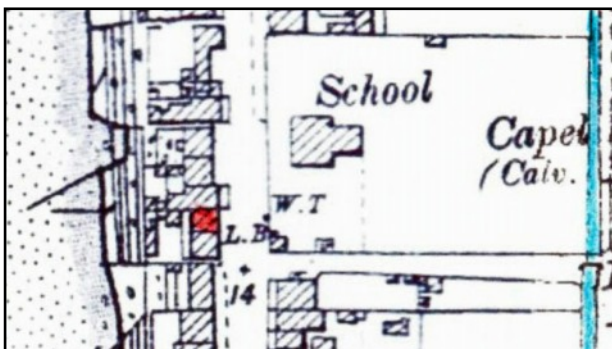

The house in 1904. It still had not an extension at the back, and was still under shared ownership. (Detail from the Ordnance Survey Map revised in 1904, published in 1905)

In 1910 for a tax planned but not levied, the house was still called Clifton House. It was owned by Jane Edwards, daughter of John Davies, and she was a seventy year old widow who owned and lived in Amity House (Celtic) next door. Occupying

Ynys View Page 4

Clifton House was Archibald Rees. Clifton House (Ynys View) was valued at £90, Amity House was £170.

At the 1911 Census the house had five main rooms. Archibald Morgan Rees was a mariner, 53 years old. His wife Sarah Alice Rees was 50 and born in Ludlow, and they had been married since 1887. Three of their children were still alive, but four had died. Two of their children were in the house; Violet Olive Rees 11, and Albert Edwin Rees 13, both born in Borth.

Sometime after 1922 furnished apartments of three bedrooms and one sitting room were offered to let in the 'Illustrated Borth Guide' (Aberystwyth Public Library).

In 1925 Florence A. Cockle owned both Celtic and Ynys View with Mary James. She had a tenant in Celtic - Evan Davies, son of John Davies of Amity House. The rate to pay for Ynys View had increased from £4.16s to £6. The same at Celtic. It is possible she had improved the houses - perhaps building the extensions at the back?

Florence paid the rates for Ynys view in 1934 and 1938 and 1949 as owner and occupier. She also owned Glasfor along the road to the north. She had one of the Davies family as a tenant in Celtic, but it is not clear if she lived one of her other two houses.

She did not have a vote for the house in 1945.

With a vote for the house in 1963, and paying the rates was Thomas W. Richards.

Archifdy Ceredigion Archives
yn cyflwyno / presents
Tai'r Borth / Houses of Borth
gan/by Beryl Lewis
[cyf/ref ADX/1629]

Mae **Tai'r Borth** yn cynnwys dros 350 hanes sy'n ymwneud ag adeiladau unigol ac mae'r hanesion wedi'u darlunio â chyfoeth o ffotograffau, mapiau a dogfennau. Mae'r ffeiliau ar gael ar ein gwefan: <https://www.archifdy-eredigion.org.uk/tairborth.php?lang=cy>

Hoffem ddiolch i Beryl am fod mor garedig â chaniatáu i ni rannu ei gwaith â'r gynulleidfa ehangaf bosibl.

Ceidw Beryl Lewis yr hawlfraint yn ei gwaith ac mae'r hanesion yn cael eu rhannu at ddibenion preifat ac ymchwil yn unig.

Houses of Borth consists of over 350 histories of individual buildings, lavishly illustrated with photographs, maps and documents. All the files are available from our website: <https://www.archifdy-eredigion.org.uk/tairborth.php>

We would like to thank Beryl for her kindness in letting us share her work with the widest possible audience.

Beryl Lewis retains the copyright in her work and the histories are made available for private use and research only.



Cyngor Sir
CEREDIGION
County Council



Archifdy
Ceredigion
Archives