

# THE BUILDINGS OF MOREFA BORTH

- the Marsh Harbour

Ceredigion



That part of Borth Village on a pebble bank with the sea on one side and the Cors Fochno marsh some reclaimed and the railway on the other. In the distance is the River Dyfi. Photograph Michael Lewis

Photographs and History by BERYL LEWIS

*This work is for research and educational purposes only.*

## TY CANOL Morfa Borth

On the beach side in the middle of Borth High Street. Formerly its address was Picton Terrace, home of Captain William Jones, and later called Ivanhoe. At one time it had the same owner as Craig Lee next door. Also home of one of the Vicars of St. Matthew's Church.



*Ty Canol in June 2015.*

Ty Canol is a single fronted terrace house of two storeys and an attic floor. It shares a gable roof parallel with the street with its neighbours. There are dormer windows in both the front and the back of the roof, and the back also has a roof light. The chimney is of rubble stone and massive, it is on the north side of the roof and is shared with Craig Lee. The walls are rubble stone and well rendered. Great care has been taken with the appearance of the front of this house and all but the dormer window are in the classical style. The front wall is divided by a string course under the upper windows, and the rendering is smooth above and has a rusticated masonry pattern below. Below the moulding of the string course are dentils. Bold quoins are drawn in the plaster on the south edge of the front. There is a strong likeness to the rendering decorating Tyrol House.



*LEFT This is Tyrol House further to the north along Borth High Street in 2015. There is a striking similarity in the decoration of these two houses. At the Census of 1891 and 1901 living there was a plasterer called Jenkin Jones, born in Aberystwyth about 1857. This too was a rubble stone house beneath the rendering. A John Thomas photograph taken in the last quarter of the nineteenth century and before 1905 shows that Ty Canol already had this nicely rendered front though both its neighbours were still exposed stone. It is possible that*

*Jenkin Jones showed off his skill in the fronts of these two houses, as the dates match.*



*LEFT A detail of Ty Canol's front door and ground floor window which has a smooth architrave frame at the sides and on the top is a pediment with swans necks topped by an arch. The windows are sash windows with twelve lights. The front door has pilasters both sides with panels inside and a circular motif in the centre. The base of the wall is picked out in black which also encloses the front door. There is a coloured tiled path, and the narrow front garden is enclosed by a low wall.*



*BELOW LEFT A detail of the cornice over the front door. The circular motif is filled by a random pattern. There is a pretty half fan below each bracket.*

*BELOW The rear of the house from the beach in 2015. The window on the wall of the main house is modern but matches the front with a pattern of small panes. The wall enclosing the yard is tall, with a gateway to the*



beach with a very solid gate. The back wall is in three materials, rubble stone at the base, then some kind of rendered wall, topped by walling of large blocks. There is an apron of hard standing beyond and Craig Lee next door has one too.

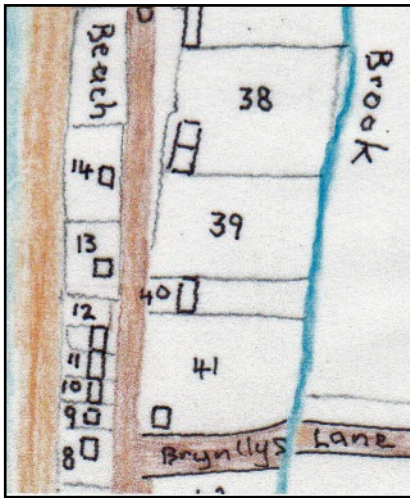

The ground for this house was enclosed in 1824 by Evan Evans from the stone bank thrown up by the sea and called 'waste' by the Crown Manor Court who owned it as it was no use for farming. His ground measured 24 perches and a map of 1829 show a cottage built on it, described as 'cottage and beach'. Evan Evans was a master mariner who owned shares in the sloop 'Liverpool Trader'. The road had been there for centuries and was a turnpike road by the 1770s. It led to a ferry from Ynyslas to Aberdovey and was a quick way to North Wales.

LEFT A detail copied from the map of 1829. Evan Evan's plot was Number 13 and he had plenty of ground around his cottage. (National Archives LRRO 1/3060)

By 1848 another cottage had been joined on to the old one on the site of Aberceldŷ). (Tithe Apportionments Map, Llanfihangel Genau'r Glyn, Cyfoeth Township, on-line at CYNEFIN.)

It is not possible to trace the occupants of the old cottage, or the date of the building of the present house at this time. However by 1870 Captain William Jones had holiday visitors staying in the house for seven weeks during the summer and it is likely the present house had been built (Cambrian News)

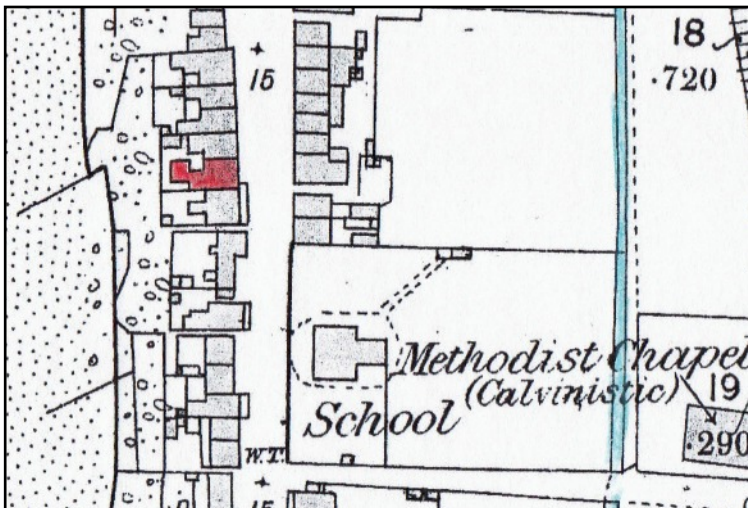

This was Captain Jones's house in 1886, marked in red. The map shows that both Ty Canol and Craig Lee had the same owner and they shared the back yard. Ty Canol was quite extensive, the house extended into the yard. The small detached building in the yard may have been the Ty Bach, outside lavatory. The fronts opened directly on to the street. (Detail from the 25 inch Ordnance Survey Map surveyed in 1885, published in 1888, Cardiganshire III.10.)



Ty Canol and Craig Lee on the right. It is a similar size and mirror image of Ty Canol.

At the 1881 Census Captain Jones was away. His wife Mary Jones, born in Borth about 1833 was in the house with her married daughter Mary Jane Hughes who was born in 1856 at Newport. Also there were her daughters Annie born about 1863 in Borth and a dressmaker in the 1901 Census, and Kate born about 1869 in Borth. In 1881 the

address of the house was Number 1 Picton Terrace. The name Picton originated from a famous army general who died at the battle of Waterloo. Ships were named after him, and a wooden sailing ship, a smack enlarged to a sloop of 40 tonnes was called 'Picton' and was owned and sailed by a Borth Jones family. Richard Jones was her master in 1836. (Shipping Register, Aberystwyth, Ceredigion Archives). It is possible that Ty Canol and Craig Lee were named after the ship - and the name Picton Terrace was later used for other houses in the row. There was also a Picton House in Morfa Borth, now Maes Arfor, another house of the Jones family of master mariners.

At the 1891 Census the house was unoccupied. By the 1901 Census in the house was a the Vicar of St Matthews, Borth, E. Tudor Evans, aged 32 and born in Glamorganshire about 1869. Also in the house was his wife Bessie Mabel Tudor Evans aged 30, born in Newtown about 1868. They had a baby daughter Marjorie and a English 'sick nurse' called Edith Mary Brown, unmarried and born in Warwick about 1870.

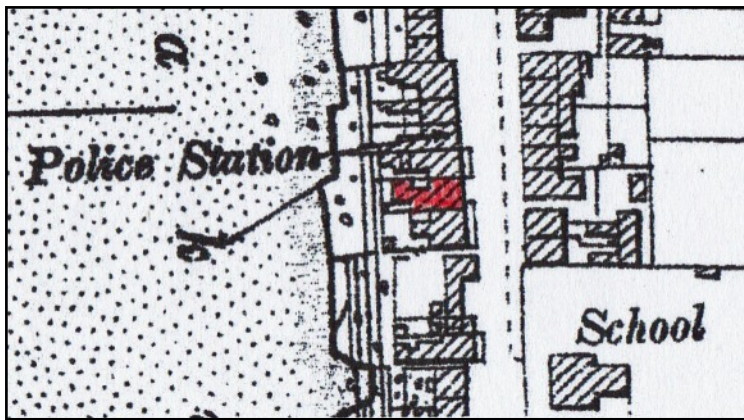

*This was the home of the Rev. Tudor Evans in 1904. The house now had a different owner from Craig Lee. There were three rows of sea defences at the back, usually stakes anchored into the stone bank, shared with Aberceldy and Craig Lee. There had been a bad storm with much damage in 1896.*

In 1910 for a valuation for a tax planned but not levied this house was valued at £220, and its address was then Number 2 Picton Terrace. There would have been £8.10s to pay, £10 gross. Despite it being wider than Craig Lee, then Number 3 Picton Terrace it was valued the same. Number 2 (Ty Canol) was owned by Anne Williams of Maesglyn, Llandre, and the occupier was David Thomas (Ceredigion Archives T/DV/18 and map at the National Library of Wales). David Thomas was a sailor, and at the 1911 Census he was away, but his wife Hannah was in the house, she was 34 and had been born in Carnarvon. They had been married for 13 years and had four children, one of whom had died. In the house then were David John Thomas aged 7 and Hannah Muriel Thomas aged 3, and the eldest, Ane Elizabeth Thomas aged 12 had been born in Liverpool. The house had nine main rooms.

In October 1924 a Mr and Mrs Davies were living there (Cambrian News). Terry Davies writes that the house was bought from Captain Hughes by Captain John Davies (1877-1937) for his parents, Evan Davies (1841 - 1924) and Margaret and for his unmarried sister Maggie (1845-1934). ('Borth, A Maritime History' p. 129). In 1925 in a list for the rates, Captain John Davies was the owner, and the occupier was Maggie Davies. In 1926 Miss Davies advertised furnished rooms to let (Trades Directory of South Wales, Ceredigion Archives). In the Illustrated Borth Guide they were three bedrooms and two sitting rooms (Aberystwyth Public Library). While Maggie Davies was living there the house was given the name 'Ivanhoe'. She and William Patterson had votes for the house in the General Election of 1945, and Maggie Davies paid the rates in 1949.

The house was to be called Ty Canol by 1963 when R. J Rees paid the rates for it, and Margaret E. D. Edwards had a vote for the house (Rates and Electoral Rolls, Ceredigion Archives). In Welsh Ty Canol means the middle house.



*In this old photograph by John Thomas Ty Canol is the second house from the left and had its pretty plastered front, its neighbours still had walls of exposed stone. Ty Canol opened directly on to the street, and has the old sash windows but no dormer window. Five houses share the same roof line (the Terrace) - but Gwendon at the far end, which was Liverpool House and a shop was taller. The date will be in the last quarter of the nineteenth century but before 1905. (Photograph on-line, National Library of Wales).*

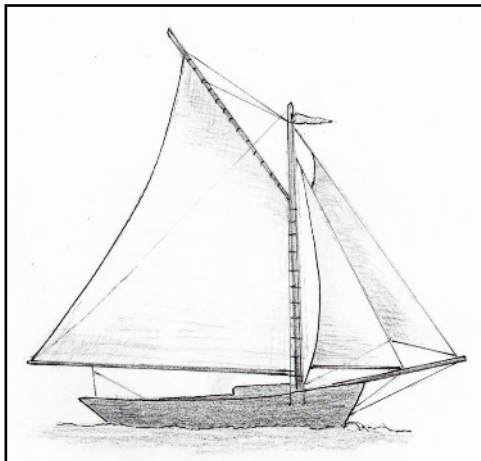

*LEFT A Sloop.*

In June 1832 Captain William Jones had shares in the 41 ton sloop 'Picton', and was master of her in 1836. He also all the shares in the 'Swallow', and nearly all the shares in the 'Victory'. He had shares other ships too. In the 1840s among the vessels he was master of were the 'Eleanor and Betsey' and the 'Mary Anne'. He had died by April 1849. (Shipping Register, Aberystwyth, Ceredigion Archives). This is probably where the money to build a good homes came from. A member of the next generation of the family, another Captain William Jones was acting as 'landlord' for holiday visitors in Number 2 Picton Terrace in 1871.

Archifdy Ceredigion Archives  
yn cyflwyno / presents  
**Tai'r Borth / Houses of Borth**  
gan/by Beryl Lewis  
[cyf/ref ADX/1629]

Mae **Tai'r Borth** yn cynnwys dros 350 hanes sy'n ymwneud ag adeiladau unigol ac mae'r hanesion wedi'u darlunio â chyfoeth o ffotograffau, mapiau a dogfennau. Mae'r ffeiliau ar gael ar ein gwefan: <https://www.archifdy-eredigion.org.uk/tairborth.php?lang=cy>

Hoffem ddiolch i Beryl am fod mor garedig â chaniatáu i ni rannu ei gwaith â'r gynulleidfa ehangaf bosibl.

Ceidw Beryl Lewis yr hawlfraint yn ei gwaith ac mae'r hanesion yn cael eu rhannu at ddibenion preifat ac ymchwil yn unig.

**Houses of Borth** consists of over 350 histories of individual buildings, lavishly illustrated with photographs, maps and documents. All the files are available from our website: <https://www.archifdy-eredigion.org.uk/tairborth.php>

We would like to thank Beryl for her kindness in letting us share her work with the widest possible audience.

Beryl Lewis retains the copyright in her work and the histories are made available for private use and research only.



Cyngor Sir  
**CEREDIGION**  
County Council



Archifdy  
Ceredigion  
Archives