

THE BUILDINGS OF MOREFA BORTH

- the Marsh Harbour

Ceredigion



That part of Borth Village on a pebble bank with the sea on one side and the Cors Fochno marsh some reclaimed and the railway on the other. In the distance is the River Dyfi. Photograph Michael Lewis

Photographs and History by BERYL LEWIS

This work is for research and educational purposes only.

THE LERRY GARAGE SITE Morfa Borth

On the beach side in the middle of Borth High Street. Ground enclosed with a cottage in 1825, a mariner's cottage and then his wife's grocery shop. Probably severely damaged in a storm of 1896. Gone by 1904. A garage there by 1949.



In 2016 this is an empty site, the remains of a disused garage building which had stood with just a roof since 2009 and was knocked down and removed in 2015. The site is classified for industrial or commercial use. At the

far end is a house on a site where the garage had previously parked its lorries, and it belonged with the garage.

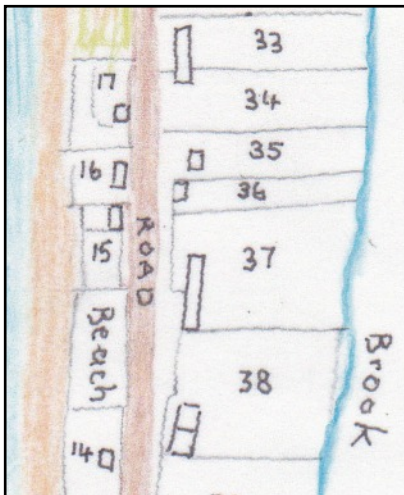

The ground for this site is the stone bank thrown up by the sea and called 'waste' by the Crown Manor who owned it as it was no use for farming. It was enclosed in 1825 by Richard Davies and measured 26 perches. On a map of 1829 it is Number 17 and there was a cottage built on it. A rent of 4s a year had to be paid for the ground - and it could be bought for two years rent of 16s. Richard Davies who died in 1849 was a master mariner with shares in various ships and he appears in the Aberystwyth Shipping Register from 1805. (Ceredigion Archives)

LEFT Richard Davies's cottage is Number 17 on this map and there was beach to the north of it. (Copy from a National Archives Map LRRO 1/3060)

The road had been there for centuries, it was used in the twelfth century and was a turnpike road by the 1770s. It led to a ferry from Ynyslas to Aberdovey and was a quick way to North Wales. Fresh water for the cottages and houses came from a brook behind the buildings on the other side of the road.



LEFT In 1848 marked in red is the cottage, then belonging to the mariner John Davies (Tithe Apportionments Map, Llanfihangel Genau'r Glyn, Cyfoeth Township. On-line at CYNEFIN, National Library of Wales)

The Davies family are in the Census of 1841. His wife Eliza was from Ffosygrafel Ucha Famr (to the south west of Borth) and was the daughter of Thomas Davies a labourer. They wed in December 1839 when John was living in Morfa Borth. They had three children, a son Evan Davies born about 1841, and daughters Mary Ann Davies born about 1843 and Margaret born about 1834.

In the cottage at the 1851 Census was Eliza Davies who had become a widow.

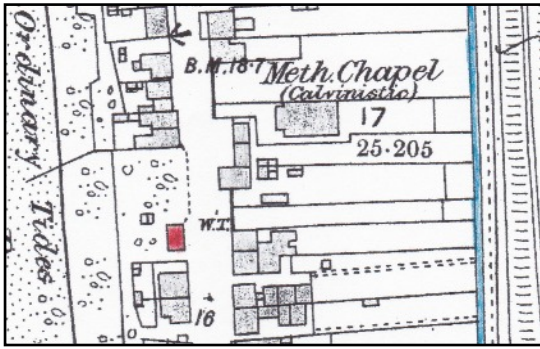

LEFT Eliza Davies Cottage in 1886 is marked in red. It had no garden, just stony beach around it, and opened directly on to the street. Its ground to the north had not been built on (Detail from the 25 inch Ordnance Survey Map surveyed in 1886 and published in 1888, Cardiganshire III.10)

By the 1871 Census she was running a grocery business in her cottage. In 1891 at the Census she was 75 years old, and the great storm of 1896 which did 'awful damage' to Cleveland (then Temperance House) and Tynsley may have ended the life of the cottage. There is an old painting that shows grass, a boat, fishing nets, and a pile of stones on the site. The grocery business moved next door to Tynsley as the mariner Williams there was a relative.



LEFT On this map of 1904 the cottage had gone. (Detail from the 25 inch Ordnance Survey Map revised in 1904 and published in 1905, Cardiganshire III.10)

In 1910 a valuation for tax planned but not levied the land that was to become a garage was owned by her son Evan Davies who lived at Glanwern, at Ivor House. He was a sailor and worked on steamships.

In 1949 David J. Davies had a Central Garage on the site, and was a flourishing business. He paid rates of £11.19s, £12 gross.



ABOVE The Central Garage after a bad storm with timbers and beyond it stone thrown up in the street by the sea. Possibly dated 1926. The words 'Central Garage' had faded but are just readable. The petrol was 'National' (Picture by courtesy of Aberystwyth Public Library - on-line 'Aftermath of a Storm at Borth')

A. Fielding paid the rates of the Central Garage in 1963.

RIGHT The Central Garage in 1964. It was brick built in two sections, and two gables at right angles to the street were roofed with corrugated iron. The fronts had Dutch style stepped brickwork, and was decorated with pilasters (flat columns). There was one narrow string course (line of moulding) and another very prominent one above the entrances. The petrol pumps stood in between the two entrances, and had 'National' petrol. The garage had an affiliation to the R.A.C.

The garage had an additional building close to the main street, a rebuild of the former Assembly Rooms behind the 'Pebbles' on the lane to St Matthew's Church which is still there today as a large garage for parking cars.

BELOW This site was vulnerable. In January 1976 there was 'devastation' at the garage after a serious storm. Alfred Fielding the owner (rear left) was showing the Ceredigion M.P. Geraint Howells and Mrs Maisie Richards the vice-chairman of the Community Council the damage. Nearer the camera was his son Geoff. In the foreground the sea had entered the building, throwing in stones and beside him was a crushed and semi-buried Hillman Imp car. Some of the roof of that section of the garage had come down and there is a glimpse of the High Street through the doorway. (Cambrian News, January 5th. 1976).





LEFT This was in March 2009. The Central Garage had become the Lerry Garage, and was out of use with the roof removed to avoid paying rates. The front of the Garage had been simplified and rendered to look more modern.

There had been a strip of ground at the north of the building where Dai John parked his lorry. The space had been filled by a house abutting the wall of the garage. The gable end faced the street and his garage was built into the ground floor.



ABOVE Spring 2014 during the demolition of the building. The colour of its red brick wall and some rendering can be seen in the foreground on the right.



This is the rear of the Lerry Garage Site in 2016. The rear wall was probably left as a defence against the sea during bad storms. On the right is the passage from the High Street to the sea.

Archifdy Ceredigion Archives
yn cyflwyno / presents
Tai'r Borth / Houses of Borth
gan/by Beryl Lewis
[cyf/ref ADX/1629]

Mae **Tai'r Borth** yn cynnwys dros 350 hanes sy'n ymwneud ag adeiladau unigol ac mae'r hanesion wedi'u darlunio â chyfoeth o ffotograffau, mapiau a dogfennau. Mae'r ffeiliau ar gael ar ein gwefan: <https://www.archifdy-ceredigion.org.uk/tairborth.php?lang=cy>

Hoffem ddiolch i Beryl am fod mor garedig â chaniatáu i ni rannu ei gwaith â'r gynulleidfa ehangaf bosibl.

Ceidw Beryl Lewis yr hawlfraint yn ei gwaith ac mae'r hanesion yn cael eu rhannu at ddibenion preifat ac ymchwil yn unig.

Houses of Borth consists of over 350 histories of individual buildings, lavishly illustrated with photographs, maps and documents. All the files are available from our website: <https://www.archifdy-ceredigion.org.uk/tairborth.php>

We would like to thank Beryl for her kindness in letting us share her work with the widest possible audience.

Beryl Lewis retains the copyright in her work and the histories are made available for private use and research only.



Cyngor Sir
CEREDIGION
County Council



Archifdy
Ceredigion
Archives