

THE BUILDINGS OF MOREFA BORTH

- the Marsh Harbour

Ceredigion



That part of Borth Village on a pebble bank with the sea on one side and the Cors Fochno marsh some reclaimed and the railway on the other. In the distance is the River Dyfi. Photograph Michael Lewis

Photographs and History by BERYL LEWIS

This work is for research and educational purposes only.

GARAGE HOUSE Morfa Borth

On the beach side in the middle of Borth High Street. Formerly part of the Lerry Garage, replacing a strip of ground where its lorry was parked, and now containing an in-built garage on the ground floor. Built after 1970.



ABOVE Garage House in 2015. Immediately in front of it is the wall of the demolished Lerry Garage, of which it was once part. Two of its ground floor rooms have windows which opened into the Garage. *LEFT* On the other side of the building is only a narrow passage before Bel-air's south wall, so having windows that side was awkward. However the door to the house is there.

This is a two storey building under a gable roof at right angles to the street. It has a long narrow site. On the upper floor a balcony overlooks the beach and there are fine views of the sea from the room at that end of the building. On a modern map

the ground floor of the building has no yard at the back, like the garage it ended at the beach. The front opens directly on to the street with the entrance to the garage.



The beach side of the house in 2016. Shutters protect the windows and below the balcony panels protect the building from the sea during bad storms.

The ground for this site is the stone bank thrown up by the sea and called ‘waste’ by the Crown Manor who owned it as it was no use for farming. It was enclosed in 1825 by Richard Davies and measured 26 perches. On a map of 1829 it is Number 17 and there was a cottage built on it. A rent of 4s a year had to be paid for the ground - and it could be bought for two years rent of 16s. Richard Davies who died in 1849 was a master mariner with shares in various ships and he appears in the Aberystwyth Shipping Register from 1805. (Ceredigion Archives) The road had been there for centuries, it was used in the twelfth century and was a turnpike road by the 1770s. It led to a ferry from Ynyslas to Aberdovey and was a quick way to North Wales. Fresh water for the cottages and houses came from a brook behind the buildings on the other side of the road.

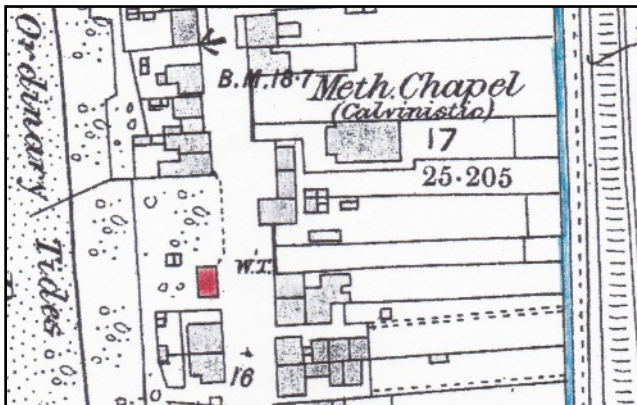

The cottage still stood in 1886, but had gone by 1905. Full details of the history of the cottage can be found in ‘Lerry Garage Site’.

LEFT The cottage on the site in 1886 is marked in red. It had no garden but rough ground around it though there was one fence to protect it from the sea. This was not good enough, as a bad storm in 1896 destroyed it. (Cambrian News, October 9th).

Garage House Page 3

The Central Garage, later the Lerry Garage was built on this land, and the house stands on the strip of land at the north of the site on which Dai John used to park the garage's lorry. Mr John lived in the house. He used to let it in the summer and slept on a mattress in the flour loft at the back of The Bakery on the other side of the street, (later a shop called the Pine Centre). In 1963 D. J. Davies paid the rates for the Central Garage (Rates, Ceredigion Archives).

In July 1970 there was still a strip of land alongside the garage called the 'parking area' adjoining the Central Garage. (Aberystwyth Rural district Council, 'Borth Sea Defences', a letter of 16 July 1970 requiring owners to allow the workmen on to their properties if needed, and with list of all the beach side properties).

The Central Garage became the Lerry Garage, and during that time this house was built.

By 2009 the garage was out of use. In 2014 it was being demolished, and the site is listed for commercial or industrial use and is still unoccupied in 2016. Garage House however remains.

Archifdy Ceredigion Archives
yn cyflwyno / presents
Tai'r Borth / Houses of Borth
gan/by Beryl Lewis
[cyf/ref ADX/1629]

Mae **Tai'r Borth** yn cynnwys dros 350 hanes sy'n ymwneud ag adeiladau unigol ac mae'r hanesion wedi'u darlunio â chyfoeth o ffotograffau, mapiau a dogfennau. Mae'r ffeiliau ar gael ar ein gwefan: <https://www.archifdy-ceredigion.org.uk/tairborth.php?lang=cy>

Hoffem ddiolch i Beryl am fod mor garedig â chaniatáu i ni rannu ei gwaith â'r gynulleidfa ehangaf bosibl.

Ceidw Beryl Lewis yr hawlfraint yn ei gwaith ac mae'r hanesion yn cael eu rhannu at ddibenion preifat ac ymchwil yn unig.

Houses of Borth consists of over 350 histories of individual buildings, lavishly illustrated with photographs, maps and documents. All the files are available from our website: <https://www.archifdy-ceredigion.org.uk/tairborth.php>

We would like to thank Beryl for her kindness in letting us share her work with the widest possible audience.

Beryl Lewis retains the copyright in her work and the histories are made available for private use and research only.



Cyngor Sir
CEREDIGION
County Council



Archifdy
Ceredigion
Archives