

# THE BUILDINGS OF MOREFA BORTH

- the Marsh Harbour

Ceredigion



That part of Borth Village on a pebble bank with the sea on one side and the Cors Fochno marsh some reclaimed and the railway on the other. In the distance is the River Dyfi. Photograph Michael Lewis

Photographs and History by BERYL LEWIS

*This work is for research and educational purposes only.*

# CANTRE GWAELOD

Set back from Princess Street in the group of homes once called Wellington Place. Formerly known as Dudley House. Developed from a cottage on the site in 1848 which has survived. An extension was approved in 1974.



*Cantre Gwaelod in 2014*

The cottage is not at right angles to the main street, but angled to suit its angled garden which is unchanged since 1848. Joined to the east end of the cottage is a modern extension of two storeys which has a passageway for cars to access its garage at the back.

It is decorated by a tile hung red area to

match the red rendering of the old cottage and provide some texture to a plain rendered wall. It has a chimney on the south end of its roof, and the windows in its eastern face will have fine views across the railway, pastures and marsh to the hills. Its garden in 1975 extended to the ditch by the railway once a brook of fresh water.



*LEFT The old cottage with a chimney on its western end. The front door is not in the centre allowing a larger room*

*which would have been the living room of the cottage with a hearth.*



*LEFT The walls are rubble stone at the front with plenty of rounded stones from the beach as was usual in Borth's oldest cottages. Mr Peter Matthews of Leronian has said that two of its walls are clom (mud). These would have had a base often knee high of stones.*



*LEFT The west end of the cottage. Its chimney is substantial with sixteen courses of pale coloured bricks.*

The rear of the house has a conservatory, there is a patio area and the long garden extends to the ditch by the railway and is grass.

*BELOW The rear of the house and its long garden taken from the old ditch.*



The ground for the building was enclosed from the pebble bank owned by the Crown Manor which considered it was 'waste' as it was no use for farming. It was Number 26 on a hand painted Crown Map of 1829 and on it were two cottages set back from the road. It was three quarters of an acre owned by a lawyer John Lewis and enclosed in 1823. A note said he sold it in 1845. However the roadside ground for the Chapel and Caer Wyddno was not yet built upon (Detail from Map of 1829, National Archives LRRO 1/3060)

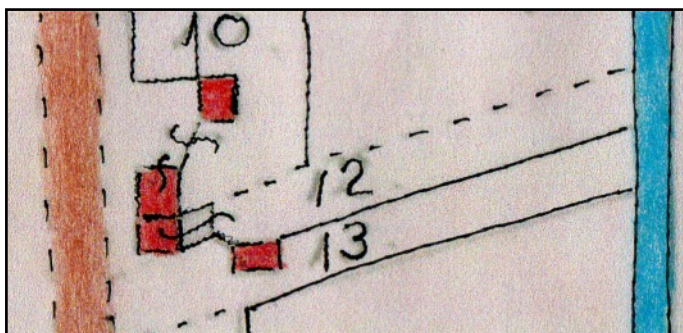

*LEFT In 1848 the cottage, Number 13, was built. It already had its long garden extending to the brook of fresh water. The owners were John Evans and Anne Daniel, and John Evans 'and others' were occupying it. The garden measured 36 perches, almost a quarter of an acre. The end of the*

*cottage was open to the street (Detail from the Tithe Apportionments Map for Llanfihangel Genau'r Glyn, Cyfoeth Township. On line at CYNEFIN)*

In the 1851 Census there are two John Evans - one was a labourer, a widower of 50 born at Gwastad Upper Borth and the other was John Seaborn Evans a 29 year old mariner and his family. They were next to each other at the Census. Ann Daniel had a cottage further south along the High Street in 1848. These two families were next door to each other again in the 1861 Census, but John Seaborn had died and his wife Ann was a widow. It is not clear what happened in the 1871 or 1881 Census.

In 1891 the cottage had a name 'Dudley Cottage'. In the cottage were a stonemason Evan Jones age 41 and born in Llanbadarn Fawr. With him was his wife Ellen a Borth woman, and daughter Margaret E. Jones aged 15, William David Jones aged 13 and Helen Jones aged 8, all born in Borth. This family only spoke Welsh (Census)

In 1901 a widow Eleanor Jones was the head of the family at Dudley Cottage, with her was 18 year old William Evan Jones aged 23 a stonemason like his father, and a three year old grandson William Jones Evans.

In 1910 for a valuation for a tax planned but not levied, the cottage then named Dudley House was valued at £60 with £1.12s to pay, £2 gross. This was a humble cottage. Ellen Jones was the owner and occupier.

In 1911 Dudley Cottage only had three main rooms. In the cottage were the widow Ellen (Eleanor) Jones then aged 65, a self employed dairymaid and grandson William Jones who was 13 (Census)

Ellen Jones paid the rates in 1925 as owner and occupier, though pencilled in is the name W. D. Jones.

William David Jones was owner and occupier paying the rates by 1934 and still in 1949. He had a vote for the house at the General Election of 1945 and so did Sarah E. Milburn.

In 1957 William David Jones had died though he was still on the list to pay the rates.

In 1963 Mrs Botttomer paid the rates, the cottage still called 'Dudley Cottage'. She did not have a vote for it (Electoral Registers and Rates, Ceredigion Archives).

In September 1974 the County Council Planning Department approved an extension for Dudley Cottage and in May 1975 it was awarded an Improvement Grant. (Minutes, Ceredigion Archives)

Archifdy Ceredigion Archives  
yn cyflwyno / presents  
**Tai'r Borth / Houses of Borth**  
gan/by Beryl Lewis  
[cyf/ref ADX/1629]

Mae **Tai'r Borth** yn cynnwys dros 350 hanes sy'n ymwneud ag adeiladau unigol ac mae'r hanesion wedi'u darlunio â chyfoeth o ffotograffau, mapiau a dogfennau. Mae'r ffeiliau ar gael ar ein gwefan: <https://www.archifdy-eredigion.org.uk/tairborth.php?lang=cy>

Hoffem ddiolch i Beryl am fod mor garedig â chaniatáu i ni rannu ei gwaith â'r gynulleidfa ehangaf bosibl.

Ceidw Beryl Lewis yr hawlfraint yn ei gwaith ac mae'r hanesion yn cael eu rhannu at ddibenion preifat ac ymchwil yn unig.

**Houses of Borth** consists of over 350 histories of individual buildings, lavishly illustrated with photographs, maps and documents. All the files are available from our website: <https://www.archifdy-eredigion.org.uk/tairborth.php>

We would like to thank Beryl for her kindness in letting us share her work with the widest possible audience.

Beryl Lewis retains the copyright in her work and the histories are made available for private use and research only.



Cyngor Sir  
**CEREDIGION**  
County Council



Archifdy  
Ceredigion  
Archives